

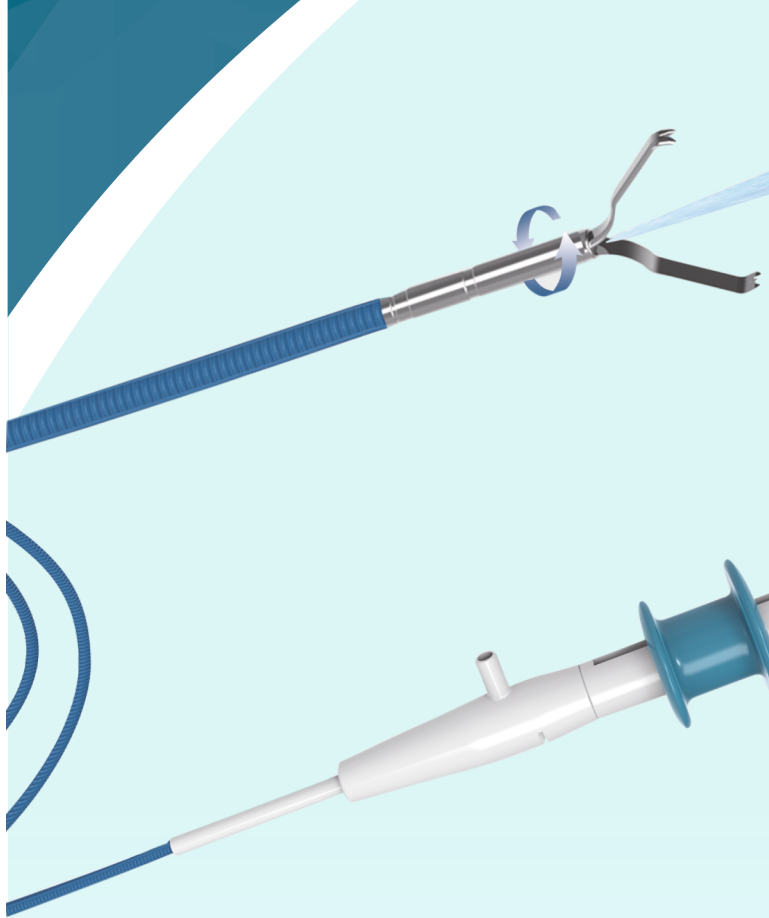

# Disposable Endoscopic Hemoclip

Easy Effective Exactly



Used to clamp soft tissue in digestive tract under the guidance of clinical endoscopy

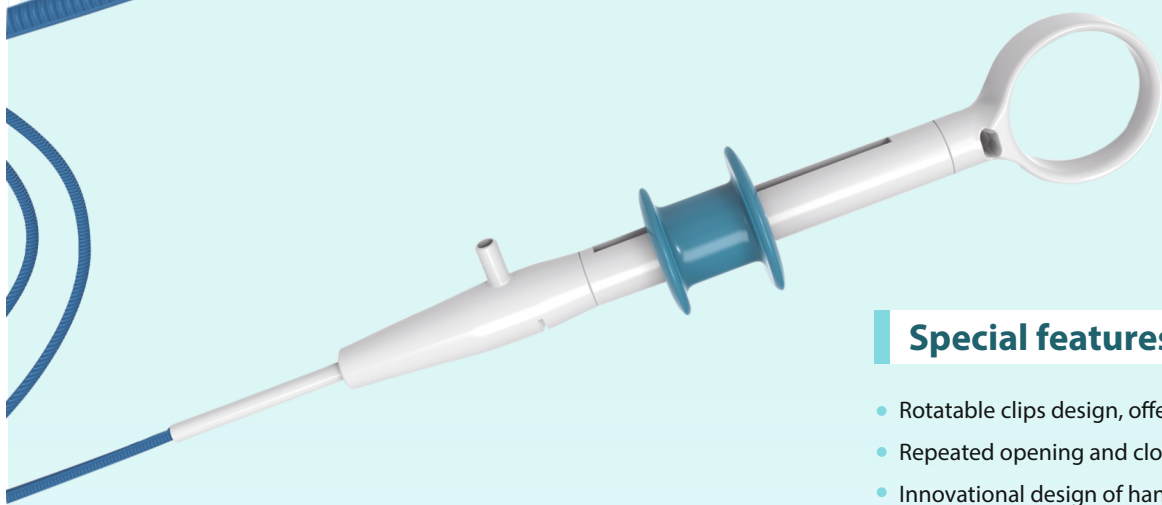

## Special features

- Rotatable clips design, offering a precise placement.
- Repeated opening and closing clips.
- Innovational design of handle lock system and atraumatic tip, avoid damage to scope after releasing clips.
- Sensitive release system, easy to release the clips.

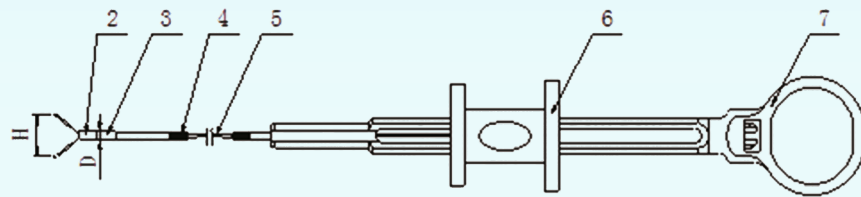

	Model	Diameter of the outer tube (mm)	Length (mm)	Actual Opening width
	<b>The Oval</b>			
	FMD-ZXJ-2300X16	2.1	2300	16
	FMD-ZXJ-1600X16	2.1	1600	16